

## The Architecture of Glass







We create innovative glass structures, individually tailored to fulfill our clients' exacting demands.

Drawing on many years' experience, our Architect-led team will transform your brief into a beautifully detailed, well-tempered end result. From the moment you contact our office, right through to the completion of your project, our professional service carries you through every stage.

At the design stage, we will prepare detailed visual images and technical proposals, explore specification options, guide you through the maze of statutory requirements, devise an appropriate procurement plan and present and analyze all the budgetary information you need.

Our project managers and skilled installers will then carry out the construction efficiently and accurately.

The projects on the following pages give an insight into our work, and we hope that they will inspire you to investigate further...



### North Lancashire

The living space of a rural cottage is transformed by a double height extension with extensive views of the surrounding landscape.





## Mayfair

Structural glazing and new aluminium sliding doors recharge a dated penthouse flat with contemporary design impact.





**Marble Hill**

Frameless glazing is used in combination with conventional construction to radically remodel and extend an existing kitchen and family dining area.





## Surrey

This Elizabethan Grade I listed monument has a 21st century guest suite linked by a glass corridor. The scheme features a 'floating' roof and huge sliding doors opening onto a paved terrace.



---

## Devon

An award-winning extension to a listed stables building designed by John Nash, now converted to a desirable country home. Completed in collaboration with McLean Quinlan Architects, it features a steel frame, extending into a veranda with hardwood louvres to provide shading.







**Dulwich**

There was little room for extension on this site, so a cramped and fussy kitchen was transformed by the removal of existing partitions and the introduction of lots of glazing to create a spacious family room.





## Mid Wales

An extension to a traditional Welsh mill which weaves together a steel frame structural glazing, hardwood doors and random stone masonry.

This project was awarded a plaque of merit for architecture at the National Eisteddfod, and received an international design and architecture award from Design Et Al magazine.







### South Coast

This complex, hardwood frame structure, combines both glazing and solid construction to create a light filled but functional space and provide architectural drama to an otherwise conventional detached house.





---

**Putney**

A hardwood frame conservatory extension to an Edwardian house. The arched window echoes an existing architectural feature of the building.



---

**Harrow on the Hill**

This project references a classical orangery, and is constructed from hardwood; large sliding doors to introduce a more contemporary feel.



---

**New Forest**

The timber frame is finished in black to co-ordinate with the weatherboarded barn style house. One side wall is fitted with sliding/folding doors that can be completely opened out to the garden.





### Gloucestershire

We used 'glulam' beams to achieve large spans and contemporary styling, although the exterior is painted hardwood to suit the local idiom in this Cotswolds village setting.



### Blackheath

This is a conventional timber frame structure but careful glazing proportions and the use of colour effectively integrate it with the 'Aesthetic' style of the house.



### East Midlands

Oak frame construction is employed to integrate a glazed structure with a barn conversion; a rare example of this type of project as it is notoriously difficult to obtain consent to extend listed barns.





### Twickenham

The brief was to add design flair to a simple lean-to extension. We introduced a monopitch three-dimensional form at right angles to the main roof, to create an unusual complex and exciting structure.

### Barnes

A simple infill structure is given impact by a structurally glazed roof featuring interlocking laminated glass beams.







#### Oxford

An expressed steel frame is combined with structural glazing to create a low profile extension extending into a long garden within a conservation area.

#### North London

Replacing a rambling sequence of functional lean-to extensions, this frameless kitchen extension, incorporating 'Pureglaze' doors is a good illustration of how large areas of glass can be incorporated within the constraints of the current Building Regulations.







#### Richmond, North Yorkshire

The challenge set by our client's architect was in the detailing; this minimal glass box at the rear of a Grade II listed townhouse has frameless 180° folding doors and mirrored stainless steel elements. Custom made or specially adapted fittings were painstakingly designed to achieve the desired effect. This project won the Chartered Institute of Architectural Technologists Alan King award, and was Highly Commended in the Northern Design Awards.

#### Chelsea

A two storey extension to the rear of a central London townhouse is an elegant composition of interlocking glass beams and fins, which support the glass roof and walls.

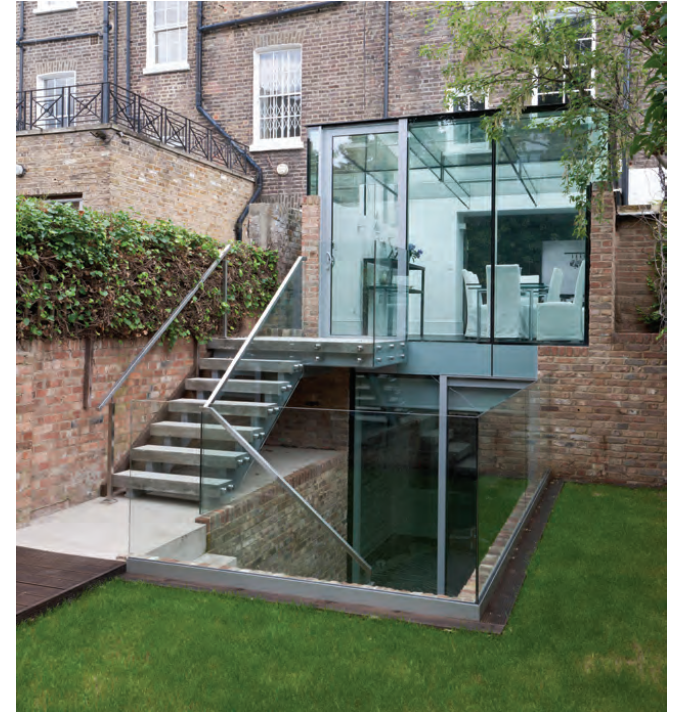



---

### Dulwich

Although this a simple design, with an architect as our client, detailing and accuracy were paramount! It consists of just three large double glazed units and three aluminium folding sliding doors, three metres in height.



---

### Richmond upon Thames

Height was a restriction in this project hence the strong horizontal emphasis to the design, but the low ceiling is opened out by a hipped, structurally glazed lantern. The frame and fascia are clad in bronze panels to give a high quality but understated finish.





#### South Kensington

A single glazed pane extends through two storeys. This is the largest double glazed unit that may be manufactured in the UK.

#### Surrey

We contributed several elements to this project including glass roofs to a family room and a pool, and a two storey glass enclosure to this stairwell.







### Lambeth

Maximum light and maximum opening width are achieved by the introduction of a structurally glazed roof and aluminium sliding folding doors which extend across the entire garden elevation.

### Hoxton Sq

The basement level of a narrow Georgian terraced house is filled with light from a minimal glazed monopitch structure vaulting a double height space.

